



## East Wintergarden – Canary Wharf

The East Wintergarden is part of Canary Wharf a self contained business and retail estate situated in East London.

The East Wintergarden is a spectacular glass building providing an attractive area for public performances and events. It will provide a public space, with direct entrances to the adjoining office buildings as well as the Jubilee Place retail mall below. The venue can be closed to the public for private evening hires and performances.

The internal dimensions are:

- 22m wide x 31m long x 27m (highest point) ceiling height
- Balcony level covers 22m wide x 12m deep of this space at 3.4 from the floor of the building

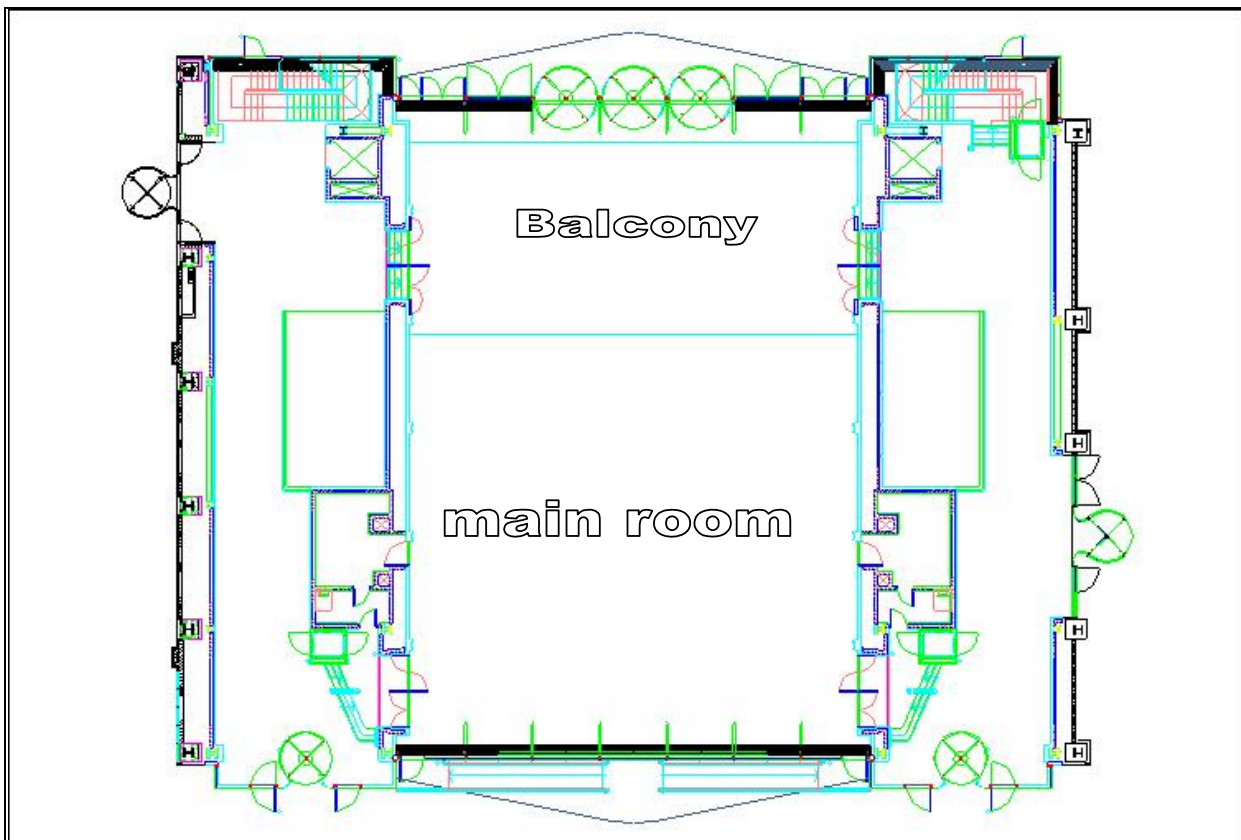

The arched construction is made from metal and glass allowing maximum natural light into the venue. The floor is marble and the walls are steamed beech wood up to a height of 8.6m. The building is fully air conditioned.

### Other Rooms

There are two small ante rooms, one on either side of the venue. The East ante room has a sink and a toilet installed and is carpeted. The West has a fitted sink and a tiled floor.

### Balcony

The Balcony has an in house restaurant / bar with seating for approximately ???????

There are also toilets on this floor.

### How to get to the East Wintergarden

By Road:

*From the City or West End:*

Via The Highway and Limehouse Link - Exit Isle of Dogs to Canary Wharf – Upper Level.

*From the North:*

Via the A102m

*From the South*

Via Blackwall Tunnel - A13

Via Rotherhithe Tunnel - A13

*From the East:*

Via the A13

There are a number of underground car parks at Canary Wharf including the newly constructed car park at Jubilee Place which has 566 spaces

Canary Wharf is also served by the Jubilee Line (Canary Wharf) and the Docklands Light Railway (Canary Wharf or Heron Keys) both stations are within 4 minutes walk of the Venue.

There are regular bus services to the Canary Wharf site - Numbers D3, D7, D8 and 277. There is also an airport shuttle bus to City Airport.

There is a river boat service from Canary Wharf Pier.

Delivery vehicles may be parked with prior arrangement at street level for unloading and loading into the venue, this subject to availability of space. There is access via large glass

doors (approximately 3m by 3.2m) and revolving doors. Due to the high profile of the Canary Wharf Estate all vehicles are subject to random security inspections on entering the site. Vehicle details should be forwarded at the earliest opportunity to allow us to pass the details on to the security department. Vehicle registration and also model and colour if known help speed up site access.

## Facilities

With the opening of Jubilee Place Mall there are 340 shops and restaurants on the Canary Wharf site.

## Technical facilities

The venue has a full rigging system made up of Prolyte H40 truss.

There is facility for a four legged ground support tower with maximum dimensions of 12m x 4m x 16m high.

Also the facility is available for flying truss in a number of different formations in the roof of the venue.

There is an in house sound system available if required based on the Meyer M1D curvilinear array speaker with a Driverack 260 system controller.

There is also a portable stage lighting system to control up to 36 channels of generic lighting, along with a stock of generic and moving head lights.

12 x 1m sq. staging units are available at 30cm high.

There are a number of 63 amp tpm supplies in the room along with some 16 amp supplies and 13amp sockets. In the floor boxes there are 13 amp sockets and facility to supply ISDN lines and network facility.